

PROCESS CAPABILITIES

- $\frac{1}{8}$ " BSPP with 17mm lock nut
- 316SS construction
- specific gravity ≥ 0.7
- temp rating: 120 °C max.
- pressure rating: 9.8 bar max.
- special threads & leads available
- special lengths made to order

ELECTRICAL CAPABILITIES

- NO or NC function by reversing float
- switching capacity: 50 Watts
- switching voltage: 240VAC / 200VDC

FLOAT DIMENSIONS:

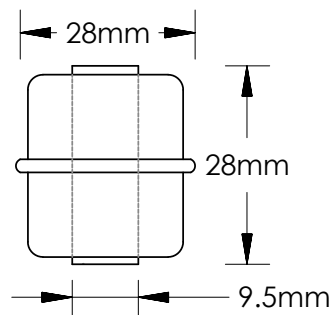

CONTROL COMPONENTS PTY LTD

CONDITIONS:

THIS DRAWING IS OUR EXCLUSIVE PROPERTY & MUST NOT BE COPIED OR HANDED TO ANY OTHER PARTIES WITHOUT WRITTEN PERMISSION. IT SHALL BE RETURNED UPON REQUEST.

UNIT 19, 15-23 KUMULLA ROAD
MIRANDA NSW 2228

PHONE: 02 9542 8977
FAX: 02 9542 7978
EMAIL: HELP@CONTROLCOMPONENTS.COM.AU

TITLE: Single float level switch with short stem - stock product.

SIZE: A4

DATE: 11/12/23

REV.7.2

REGISTRY

SCANNED

SCALE: NTS

DRAWN BY: BGM

CCS-1-FL-1/8Tx - stock